

Bevmax Office Centers 75 Rockefeller Plaza Center offers professional and executive workspaces in world renowned Rockefeller Center, the heart of Mid-town Manhattan. Our Center is within 1 block of the General Electric, NBC, UBS Paine Webber, Lazard Ltd., and News Corporation World Wide Headquarters.

The 75 Rockefeller Plaza Center is also within 1 block of the world famous Saks Fifth Avenue, "21" Club, St. Patrick's Cathedral, the E, V, B, D, and F subway lines and within 3 blocks of the Lexington Avenue 4, 5, 6, subway lines. It is a five minute walk to the North Entrance of Grand Central Station.

Our Center boasts an extraordinary, dynamic and sophisticated collection of original artwork and spectacular views of the world famous St. Patrick's Cathedral and Rockefeller Center.

The 75 Rockefeller Plaza Center has 78 fully furnished and wired offices, two large conference rooms, and a large pantry/break room serving freshly brewed Starbucks Coffee and a continental breakfast every morning.

All of Bevmax's offices are equipped with state-of-the art telephone and high-speed Internet access. Bevmax makes it easy for you to be in your new office, complete with telephone, Internet, secretarial, receptionist, mail and conference room services today, allowing you to concentrate on your business today!

Office packages include:

- Fully-furnished private offices
- Live phone reception
- High-speed Internet (T1) access
- Advanced digital phone system
- Conference rooms and reception area
- Secure 24/7 access
- Daily office cleaning
- Dynamic, contemporary art exhibits curated by Craig R. Michel of Owl57 Galleries.

Flexibility for your business

Bevmax Office Centers makes it easy to set up your office. You won't have to worry about buying office furniture, setting up telephones and Internet access.

Immediate availability

Your company can be up and running in a new office with telephone, Internet access and conference room in less than a day.



View from office 1821



View from office 1826

- A** Private executive office for one to three persons.
- B** Boardroom/conference room. Meetings for up to 25 people.
- C** Pantry, fully-equipped with refrigerator, microwave, toaster oven, and Starbucks Coffee brewed daily.
- D** Large team rooms for up to eight persons.

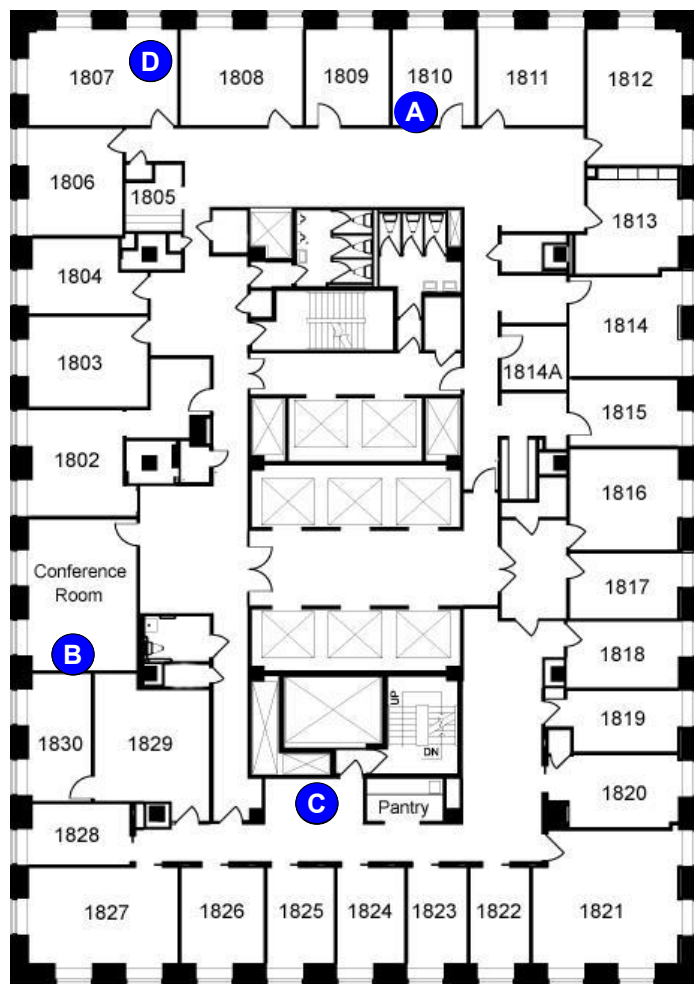

Bevmax Office Centers
75 Rockefeller Plaza
18th Floor

212-989-8900



Bevmax Office Centers
212-989-8900 ext. 333
www.BevmaxOffice.com